

Mounting Instructions

The Expedition

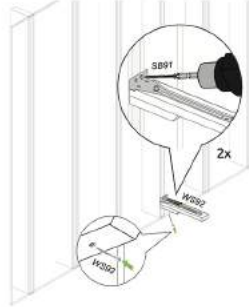
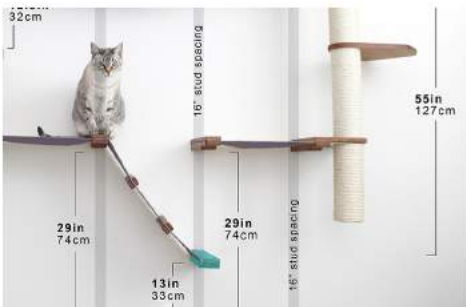
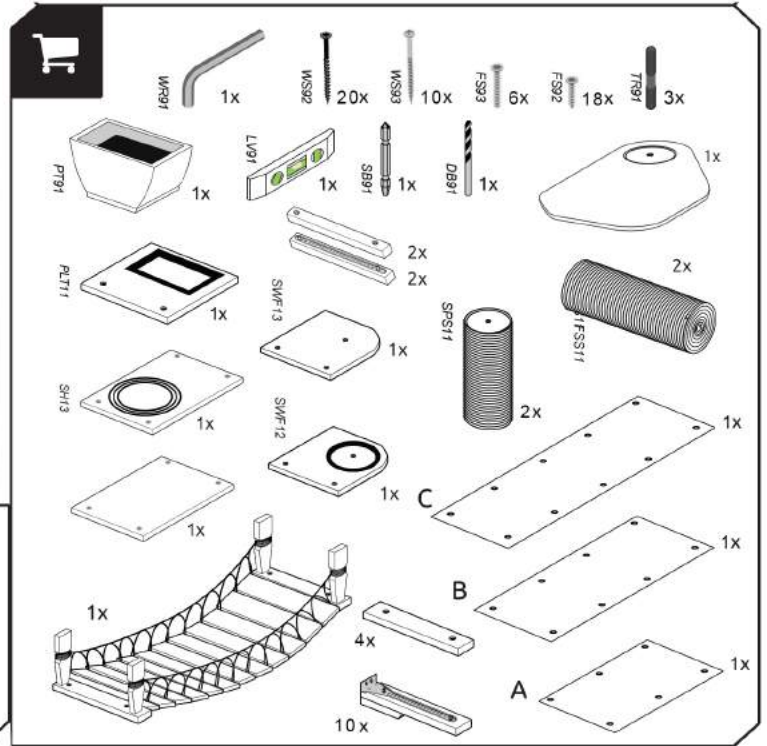
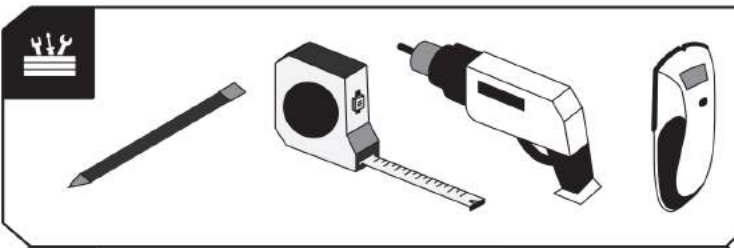
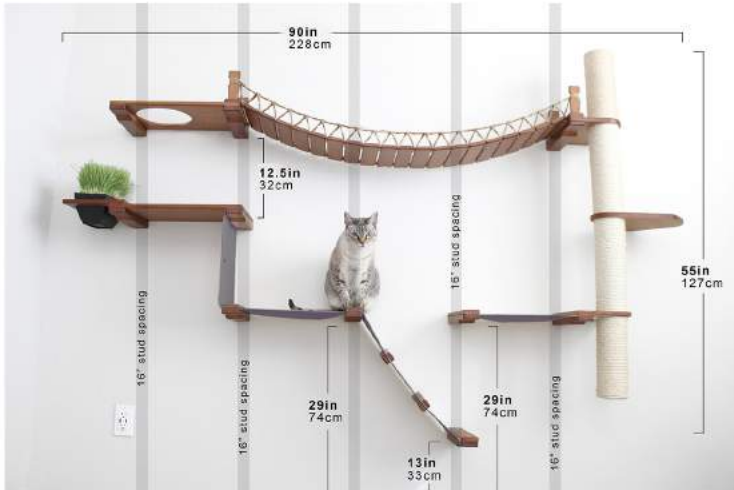

Step 1

This layout uses 5 studs spaced out at 16". Starting with the 2nd stud from the right, install a mounting plank with the bottom measuring 13 inches from the ground.

Use 2 wood screws (WS92) in the top two bracket holes and a longer wood screw (WS93) in the bottom hole.

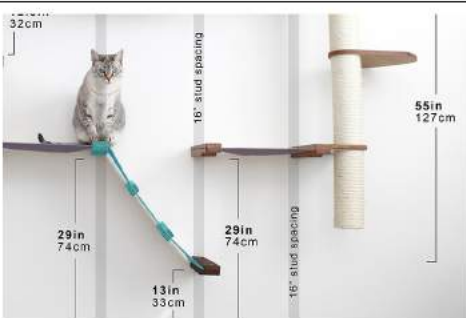

Step 2

Connect Fabric B to the mounting plank and attach the plank top with furniture screws (FS92) to hold the fabric firmly in place.

Next, attach the other side of Fabric B to a mounting plank, stretch the fabric up and left to the next stud and mount the plank 29" from the ground.

Lastly, attach the ladder pieces into the two sets of grommets along the fabric using furniture screws (FS92).

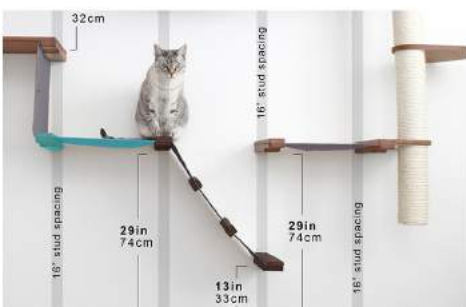

Step 3

Attach Fabric C to the plank bottom you just mounted and install a plank top to securely hold the fabric in place.

Place the middle set of grommets over the mounting posts of another plank and pull directly left to the following wall stud. You can place a level on the fabric if you would like it to be perfectly straight.

Install the plank into position and attach the plank top to hold the fabric in place.

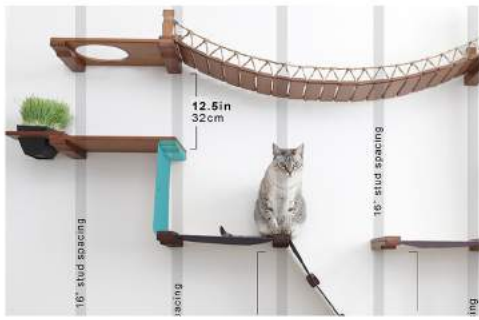

Step 4

With the last set of grommets on Fabric C attached to another mounting plank, pull straight up so that the fabric is taut and install the mounting plank.

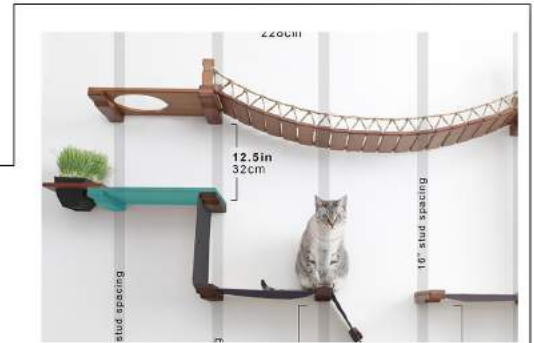

Step 5

Hold the Solid Shelf Top together with another mounting plank and place the other end of the shelf over the plank you just installed. Place the level on the shelf and install the bottom hole of the mounting plank to hold it in place. Remove the shelf and install the two top bracket holes to install the plank securely to the wall.

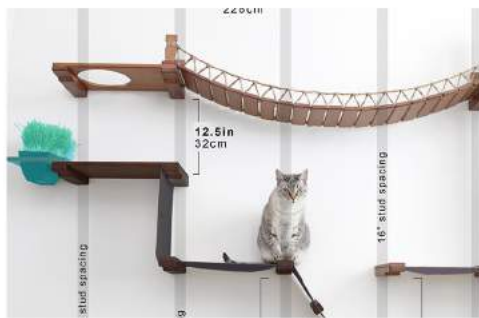

Step 6

Place the Planter Top over the left side of the shelf and use the two longer furniture bolts (FS93) to attach the Planter Top to the Solid Shelf.

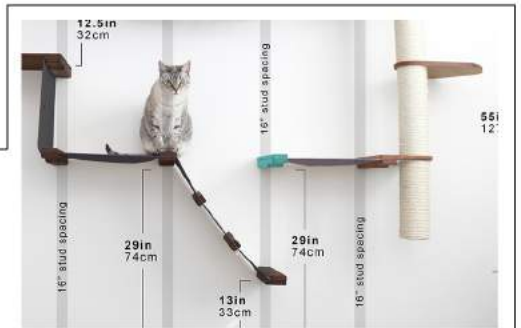

Step 7

Install a mounting plank directly above the first one you installed and make sure it's the same distance from the ground as other planks you've mounted at the same level.

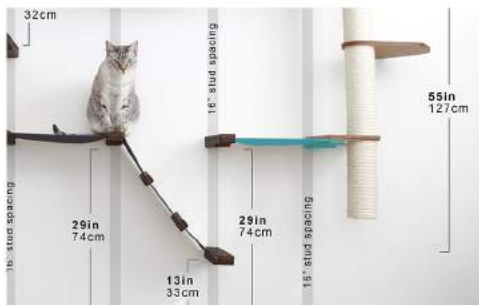

Step 8

Attach Fabric A onto the plank and install a plank top to hold the fabric in place.

Using another plank bottom, attach the last set of grommets, pull directly to the right, and install the plank bottom into the stud.

Step 9

Attach all the sections of the scratching pole together using threaded rods between each section as shown, twisting pieces clockwise until they're firmly held together.

*Please note that if you continue rotating pieces too far once they're snug, you can force the metal inserts out of the pole and damage it.

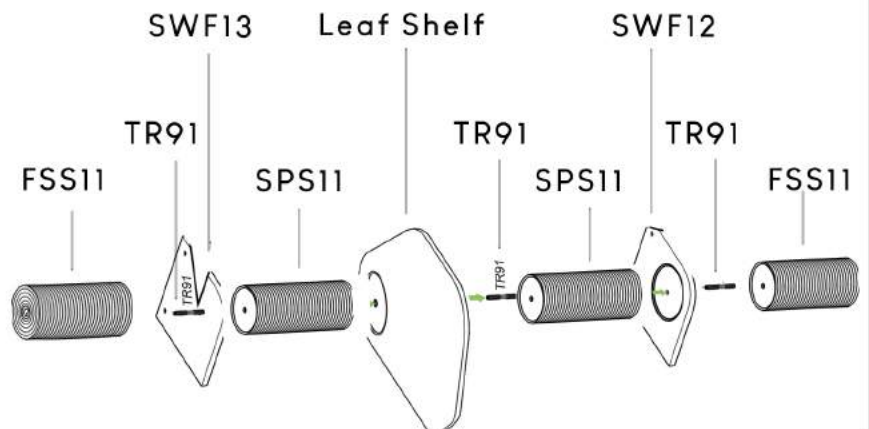

Step 10

Place the bottom side of the sisal pole over the bottom mounting plank.

Place another plank bottom into the holes of the top platform and, holding a level against the sisal pole, find the position of the top mounting plank.

Install a long wood screw (WS93) into the bottom mounting hole of the plank. Remove the pole and install two wood screws (WS92) into the top bracket holes.

Place the sisal pole back on the mounting planks and use shorter furniture screws (FS92) to attach the pole platform to the bottom plank.

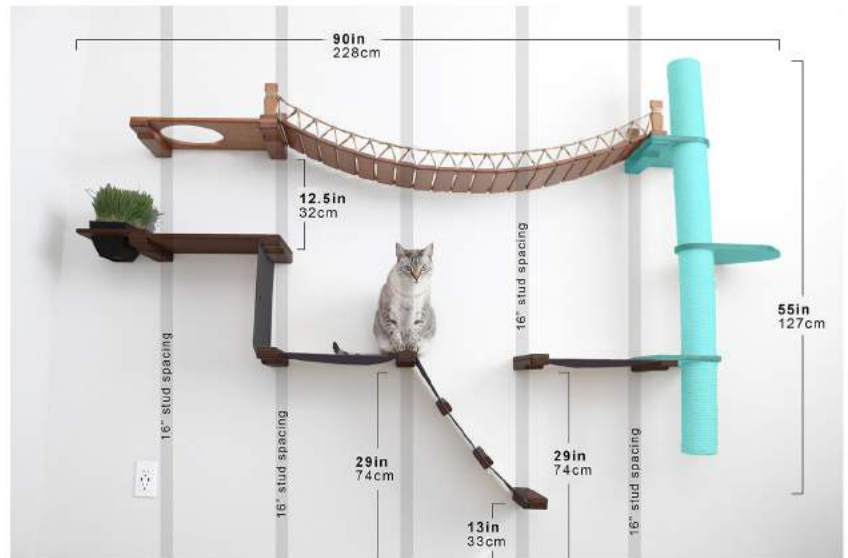

Step 11

Place one side of the bridge over the top sisal pole platform and attach, using longer furniture screws (FS93) and the allen wrench.

Using another plank and the other side of the bridge, pull the bridge over to the left so that it's lined up with the plank positioned below and it's 12.5" above the solid shelf. Install a long wood screw (WS93) into the bottom mounting hole of the plank. Remove the bridge and install two shorter screws (WS92) in the top mounting bracket.

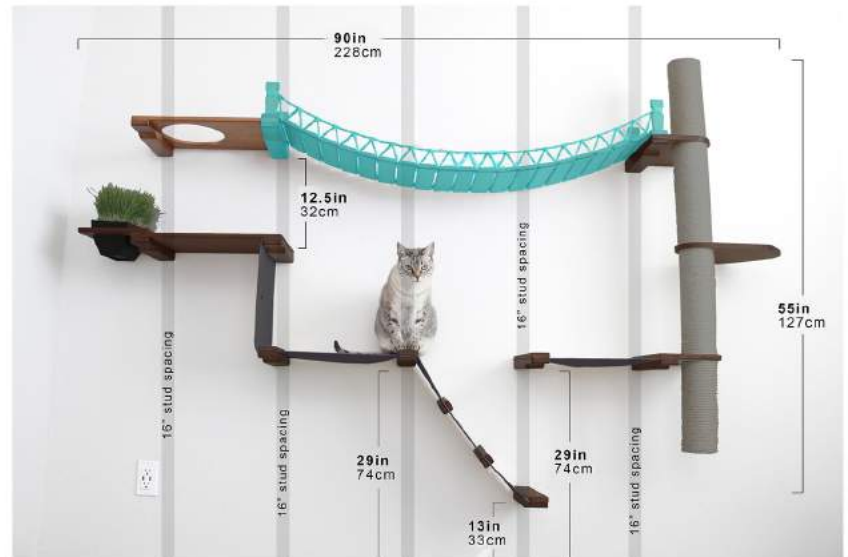

Step 12

With the bridge still removed, set the right side of the Escape Hatch shelf on the plank and, holding the last mounting plank on the left side of the shelf, use the level to find the position.

Install the plank into the stud using the bottom mounting hole and longer wood screw (WS93). Remove the shelf and install the top two wood screws (WS92) into the top of the bracket.

Place the shelf back on the planks and attach the left side into place with short furniture screws (FS92). Place the bridge over the right side and use longer furniture screws (FS93) to hold the shelf and bridge together.

